

Thermal overload relay J7TC Series

Motor Protection from Overload and Phase -loss by Combination with J7KC for up to 2.2 kW (240 VAC) *, 5.5 kW (440 VAC)



- Push-In Plus wiring Technology saves Wiring and Maintenance time
- One-touch Installation with magnetic contactor J7KC to configure a magnetic starter
- High-reliability auxiliary circuit (2PST-1NO 1NC)
- Equipped with a dial cover as standard to suppress setting changes
- Easily switch between manual and automatic reset methods
- Certified as compliant with the main safety standards

* Based on JIS C 8201-4-1

For the most recent information on models that have been certified for safety standards, refer to your OMRON website.

Refer to *Safety Precautions* on page 9.

Model Number Structure

Model Number Legend Order according to the format described in Ordering Information.

J7TC- 01 - □□□

For J7KC (1)

(1) Trip current

Code	Settling current range
E15	0.1-0.15 A
E20	0.13-0.2 A
E27	0.18-0.27 A
E36	0.24-0.36 A
E52	0.34-0.52 A
E72	0.48-0.72 A
E96	0.64-0.96 A
1E2	0.8-1.2 A
1E4	0.95-1.45 A
1E6	1.1-1.65 A

Code	Settling current range
2E1	1.4-2.1 A
2E6	1.7-2.6 A
3E4	2.2-3.4 A
4E2	2.8-4.2 A
6	4-6 A
7E5	5-7.5 A
9	6-9 A
10	7-10.5 A
13	9-13 A

J7TC Series

Ordering Information

Main unit

Thermal overload relay

Setting current range	Model
0.1-0.15 A	J7TC-01-E15
0.13-0.2 A	J7TC-01-E20
0.18-0.27 A	J7TC-01-E27
0.24-0.36 A	J7TC-01-E36
0.34-0.52 A	J7TC-01-E52
0.48-0.72 A	J7TC-01-E72
0.64-0.96 A	J7TC-01-E96
0.8-1.2 A	J7TC-01-1E2
0.95-1.45 A	J7TC-01-1E4
1.1-1.65 A	J7TC-01-1E6
1.4-2.1 A	J7TC-01-2E1
1.7-2.6 A	J7TC-01-2E6
2.2-3.4 A	J7TC-01-3E4
2.8-4.2 A	J7TC-01-4E2
4-6 A	J7TC-01-6
5-7.5 A	J7TC-01-7E5
6-9 A	J7TC-01-9
7-10.5 A	J7TC-01-10
9-13 A	J7TC-01-13

Accessories (Order Separately)

Insulation stop

Model	Minimum order (bag)
J77KC-T (for main circuit)	1 (30 pcs./bag)
J77KC-K (for auxiliary circuit)	

Removal tool

Model
J78KC

For selection of J7TC for each motor capacity, refer to the following table.

3-phase standard motor capacity and full load current (reference values)			Setting current range [A]	Thermal overload relay model	Magnetic contactor model
Main circuit voltage	Capacity [kW]	Current [A]			
200-240 VAC	0.1	0.68	0.48-0.72	J7TC-01-E72	J7KC-12
	0.2	1.3	0.95-1.45	J7TC-01-1E4	
	0.4	2.3	1.7-2.6	J7TC-01-2E6	
	0.75	3.8	2.8-4.2	J7TC-01-4E2	
	1.5	7	5-7.5	J7TC-01-7E5	
	2.2	9.8	7-10.5	J7TC-01-10	
380-440 VAC	0.2	0.65	0.48-0.72	J7TC-01-E72	
	0.4	1.15	0.8-1.2	J7TC-01-1E2	
	0.75	1.9	1.4-2.1	J7TC-01-2E1	
	1.5	3.5	2.8-4.2	J7TC-01-4E2	
	2.2	4.9	4-6	J7TC-01-6	
	3.7	8	6-9	J7TC-01-9	
	5.5	11.9	9-13	J7TC-01-13	

Note: The 3-phase motor full load current is a reference value. When applying, check the full load current of the motor you will use.

Ratings/Specifications

Ratings/Specifications

Main circuit rating	Trip class		10 A						
	3-pole load operation (At 20°C ambient temperature) IEC 60947-4-1/ JIS C 8201-4-1	Limit operation	No operation (cold start)	105% (less than 2 hours) *1					
			Operation (hot start)	120% (less than 2 hours) *1					
		Operation when overload occurs (hot start)		150% (less than 2 minutes) *1					
		Operation when locking occurs (cold start)		720% (over 2 s up to 10 s) *1					
	2-pole load operation (At 20°C ambient temperature) IEC 60947-4-1/ JIS C 8201-4-1	Phase less protection device		With phase failure protection device					
		No operation (cold start)		2 poles 100%/1 pole 90% *1					
		Operation (hot start)		2 poles 115%/1 pole 0% (less than 2 hours) *1					
	Ambient temperature compensation performance	Ambient temperature 40°C	No operation (cold start)	100% (less than 2 hours) *1					
			Operation (hot start)	120% (less than 2 hours) *1					
Ambient temperature -5°C		No operation (cold start)	105% (less than 2 hours) *1						
		Operation (hot start)	130% (less than 2 hours) *1						
Auxiliary circuit rating	Ratings based on IEC 60947-5-1	Rated voltage range (V)		24	100-120	200-240	380-440	500-600	
		Rated operational current (A)	AC-15 (Coil load)	NC contact	3.0 (0.5) *2	2.5 (0.5) *2	2.0 (0.5) *2	1.0 (0.5) *2	0.6 (0.5) *2
				NO contact	3.0 (0.5) *2	2.5 (0.5) *2	1.5 (0.5) *2	0.75 (0.5) *2	0.6 (0.5) *2
		DC-13 (Coil load)	NC contact	1.1 (0.3) *2	0.28	0.14	---	---	
			NO contact	1.1 (0.3) *2	0.28	0.14	---	---	
	Conventional free air thermal current (Rated carry current)		5 A						
	Ratings based on UL 508	Rated carry current (A)		5				1	
		Rated voltage (V)		120 AC	240 AC	480 AC	600 AC	125 DC	250 DC
		Contact closed current (A)		30	15	7.5	6	0.22	0.11
		Breaking current (A)		3	1.5	0.75	0.6	0.22	0.11
		Rating code		B600				Q300	
	Minimum operate voltage/current (reference value)		5 VDC, 3 mA						
	Contact resistance (reference value)		50 mΩ max. (6 VDC, 1 A, voltage drop method)						
	Contact structure		Single-break						
	Contact material		Ag alloy						
Rated insulation voltage		690VAC							
Rated impulse dielectric strength		6 kV							
Rated frequency		50/60 Hz							
Vibration resistance		Vibration: 10 to 55 Hz, acceleration: 15m/s ²							
Shock resistance		Shock value 50 m/s ²							
Degree of protection		IP20 (IEC60529)							
Operating temperature		-10 to +55°C (however, daily average shall not exceed 35°C)							
Ambient storage temperature		-40 to +65°C (no condensation or icing)							
Relative humidity		45% to 85% RH (no condensation or icing)							
Altitude		2000 m max.							
Weight		110 g							
Applicable standards		Safety standard EN 60947-4-1 (IEC 60947-4-1), UL 60947-4-1, CSA 22.2 No.60947-4-1, CCC GB/T 14048.4, UKCA							

*1. Ratio to dial settling current

*2. () indicates the contact rating when set to auto release

J7TC Series

Engineering Data

Operating characteristics curves

Trip class 10 A

Cold-start characteristics (20°C ambient temperature)

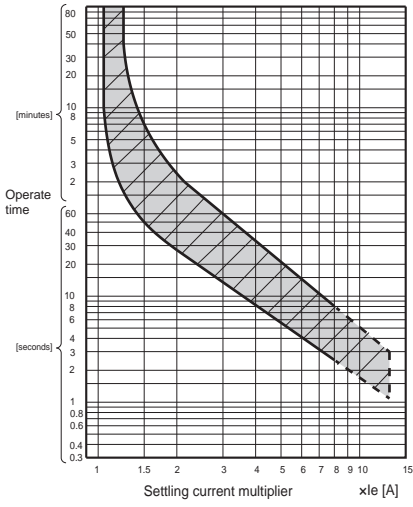

Hot-start characteristics (20°C ambient temperature)

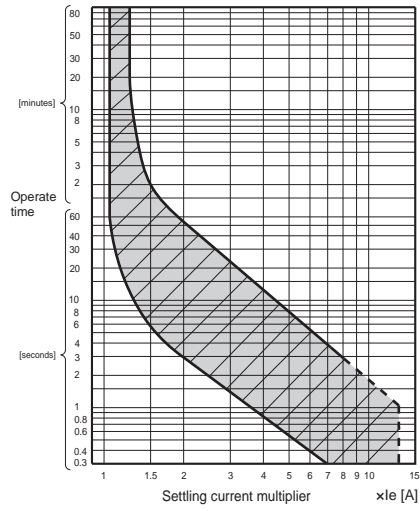

(Average values) (Ambient temperature 20°C)

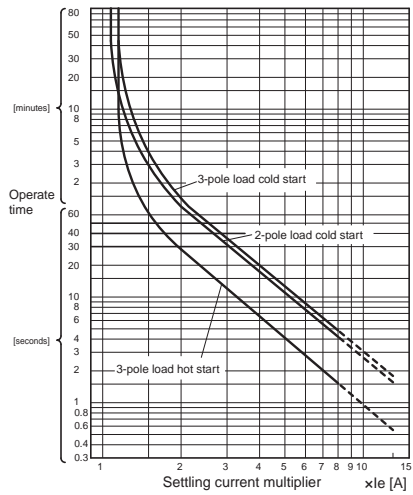

Nomenclature

J7TC

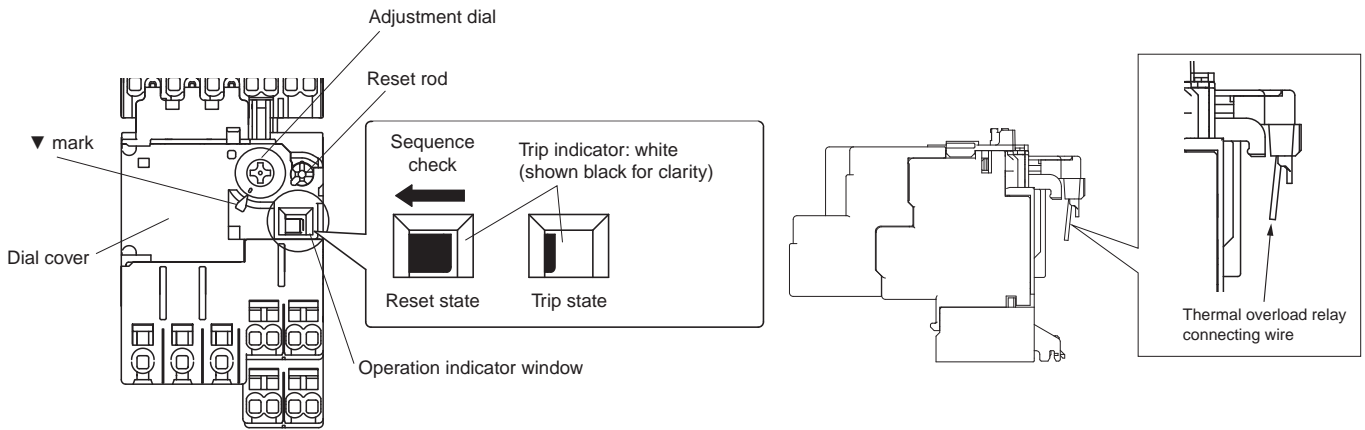

Dimensions

(Units: mm)

Main unit

J7TC

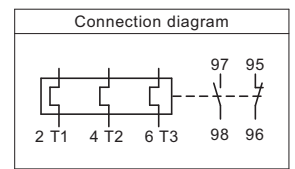
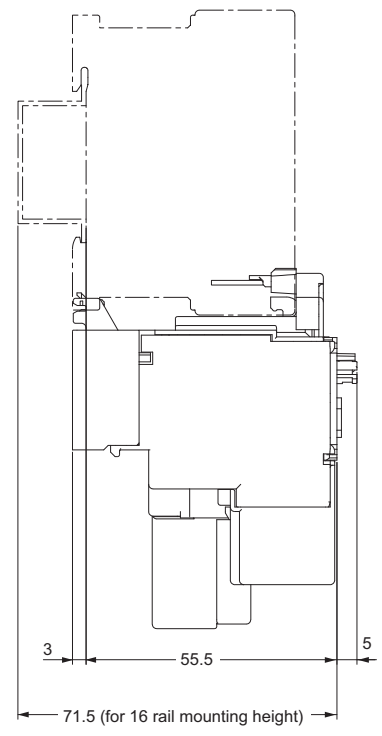
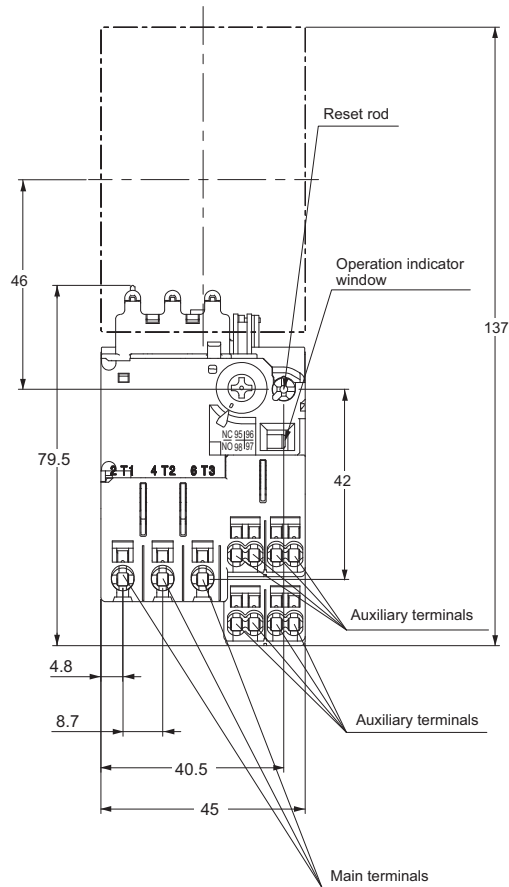

Product main unit arrangement

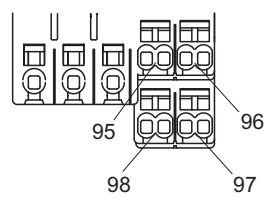

Product main unit print

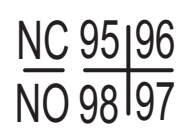

Note: Although the connection diagram shows auxiliary contacts (NC, NO) arranged horizontally, the NC and NO terminals are aligned vertically as shown in the product main unit print.

J7TC Series

Related Products (Order Separately)

Magnetic contactor J7KC

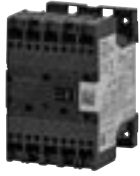

J7KC

+



J7TC

=



Magnetic starters

When using a thermal overload relay, combine it with a magnetic contactor to use it as a magnetic switch.

Coordination with the short circuit protection device (SCPD) (based on IEC and JIS standards)

Assumed short circuit current "r" (240 V, 440 V)

Magnetic starters			Coordination type				
Magnetic contactor	Thermal overload relay		Type 1			Type 2	
	Setting current range [A]	Short-circuit current "r" [kA]	Breaker EN60947-2	Rating [A]	Short-circuit current "r" [kA]	Fuse rating [A] (IEC 60269-1 gG and gM)	
J7KC-12	J7TC-01	0.34-0.52	1	Breaker for wiring protection (MCCB) Icu 240 V 5 kA 440 V 2.5 kA	3	1	2
		0.48-0.72			5		4
		0.64-0.96			10		16
		0.8-1.2			20		
		0.95-1.45					
		1.1-1.65					
		1.4-2.1					
		1.7-2.6					
		2.2-3.4					
		2.8-4.2					
		4-6					
		5-7.5					
		6-9			30		
7-10.5							
9-13							

Conditional rated short circuit current Iq (240 V)

Magnetic starters			Coordination type					
Magnetic contactor	Thermal overload relay		Type 1			Type 2		
	Setting current range [A]	Short-circuit current "Iq" [kA]	Breaker EN60947-2	Rating [A]	Short-circuit current "Iq" [kA]	Fuse rating [A] (IEC 60269-1 gG and gM)		
J7KC-12	J7TC-01	0.34-0.52	25	Breaker for wiring protection (MCCB) Icu 240 V 5 kA 440 V 2.5 kA	3	50	2	
		0.48-0.72			5		4	
		0.64-0.96			10		16	
		0.8-1.2						20
		0.95-1.45						
		1.1-1.65						
		1.4-2.1						
		1.7-2.6						
		2.2-3.4						
		2.8-4.2						
		4-6						
		5-7.5						
		6-9			30		20	
7-10.5								
9-13								

Options (order separately)

(Unit: mm)

Insulation stop

For main circuit

J77KC-T



For auxiliary circuit

J77KC-K



Guide for insertion into terminal (insertion) holes to stabilize holding of 1mm² or less stranded wire (direct insertion).

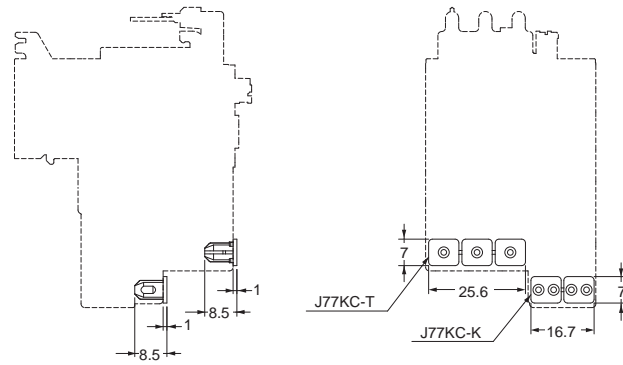

Removal tool

J78KC

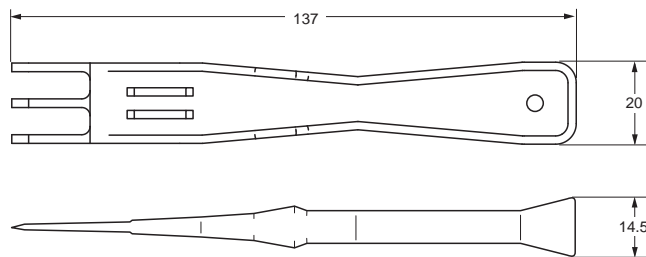

J7TC Series

DIN Rails (Order Separately)

(Unit: mm)

Mounting Rail PFP-100N PFP-50N

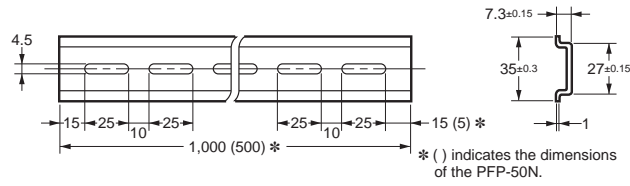
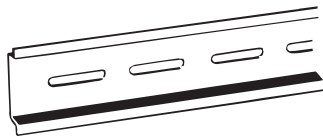

Model
PFP-100N
PFP-50N

Mounting Rail PFP-100N2

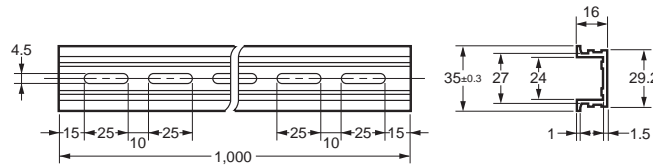
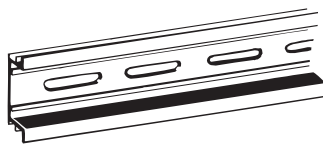

Model
PFP-100N2

End Plate PFP-M

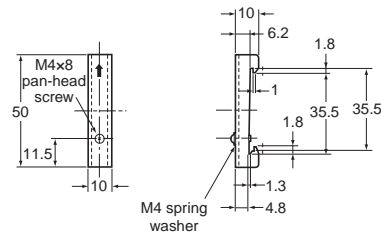
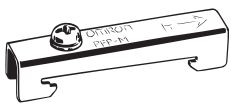

Model
PFP-M

Spacer PFP-S

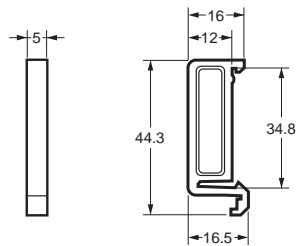
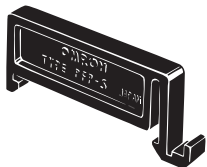

Model
PFP-S





Note: 1. Order the parts above in units of ten. The prices shown above are standard prices for one piece.
2. Rails conform to DIN standards.

Safety Precautions

Warning Indications

 CAUTION	Indicates a potentially hazardous situation which, if not avoided, is likely to result in minor or moderate injury or property damage.
Precautions for Safe Use	Supplementary comments on what to do or avoid doing, to use the product safely.
Precautions for Correct Use	Supplementary comments on what to do or avoid doing to prevent failure to operate, malfunction, or undesirable effects on product performance.

Meaning of Product Safety Symbols

	Used to warn of the risk of electric shock under specific conditions.
	Used to indicate prohibition when there is a risk of minor injury from electric shock or other source if the product is disassembled.
	Used for general prohibitions for which there is no specific symbol.
	Used for general mandatory action precautions for which there is no specified symbol.

CAUTION

Do not touch or approach the product while or immediately after power is supplied. This may result in electric shock or burn injuries.



Minor electric shock, fire, or malfunction may occasionally occur.

Never disassemble, modify, or repair the product or touch any of the internal parts.



Do not use the product in an environment where flammable or explosive gas is present.



When replacing the magnetic contactor, also replace the thermal overload relay at the same time.



Precautions for Safe Use

- Do not use the product in any of the following locations.
 - Places subject to intense temperature changes.
 - Places subject to high humidity or condensation.
 - Places subject to intense vibration or shock.
 - Places subject to considerable dust or corrosive gas, or directly exposed to sunlight.
 - Places subject to splashing water, oil, or chemicals.
- Do not store or use in conditions that subject the product to an external load.
- Install securely on the magnetic contactor.
- Never drop the product or allow it to fall.
- Make sure that foreign matter does not collect or enter into the terminal (insertion) hole or release hole. Smoking or ignition, malfunctioning, or failure may occur.
- Do not use the product at less than the minimum applicable load.
- Never use at a load that exceeds the rated capacity.
- If the circuit is a two-wire circuit and auto reset takes place, the motor will automatically restart when the thermal relay automatically resets. Exercise caution.
- Use wire, ferrules, and tools with the required specifications. Strip the wires to the specified length, and use ferrules of the specified length. Fully insert them to the back of the terminal (insertion) holes. (For details, refer to the information on pages 13 and 14.)
- If directly inserting wire, always use tin-plated strand wire.
- Do not insert multiple wires into one terminal (insertion) hole.
- Do not wire terminals that are not used.
- Make sure all wiring connections are correct before supplying power.
- Do not accidentally insert a wire into the release hole.
- Do not bend a wire past its natural bending radius or pull on it with excessive force.
- After inserting the tool into the release hole, do not pry with the tool.
- Do not insert the tool into the terminal (insertion) hole.
- Do not supply power while the tool is inserted into the release hole.
- Do not insert anything other than the specified tool into the release hole.
- Wipe off any dirt from the product with a soft dry cloth. Never use thinners, benzine, alcohol, or any cleaners that contain these or other organic solvents. Deformation or discoloration may occur.
- When disposing of the product, follow local disposal procedures for industrial waste.

Precautions for Correct Use

- Avoid use in a location with many magnetic particles. Risk of failure.

Mounting, removal, setting, and wiring (connection)

Installing the thermal overload relay

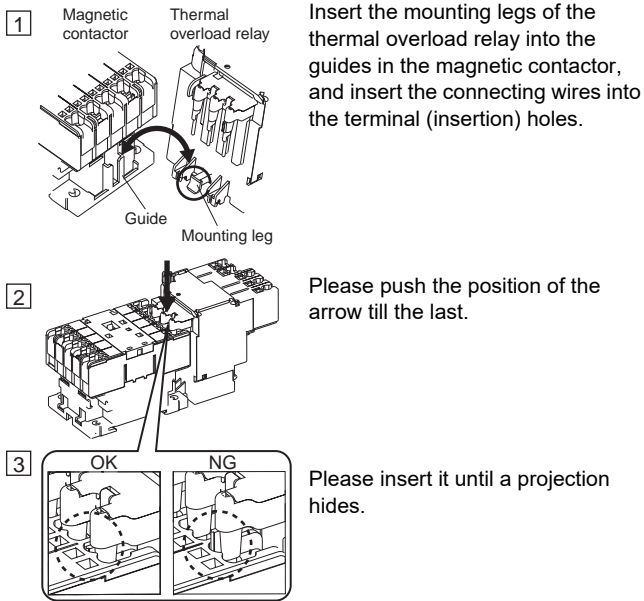

Insert the mounting legs of the thermal overload relay into the guides in the magnetic contactor, and insert the connecting wires into the terminal (insertion) holes.

Please push the position of the arrow till the last.

Please insert it until a projection hides.

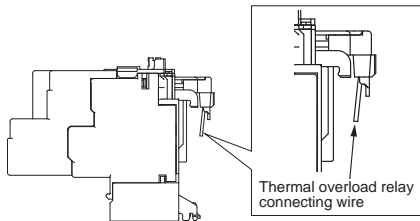

- * The connecting wires are manufactured at an angle. Be sure not to change the shape of the connection terminals.
- * Thermal overload relays cannot be used for auxiliary relays.

Mounting on rail

Follow the procedures below to mount the product on the rail or remove it from the rail.

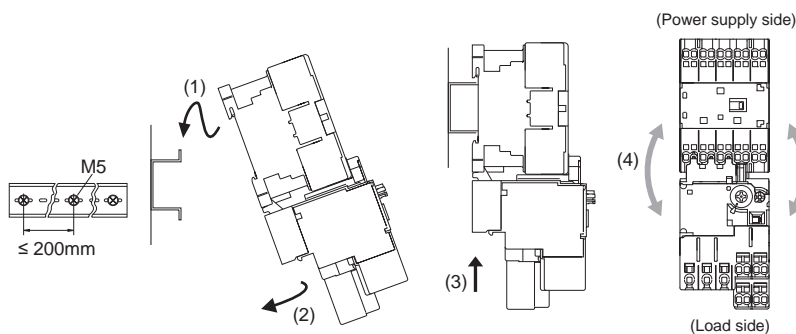

When mounting on a rail, use the end plate.

Removing from rail

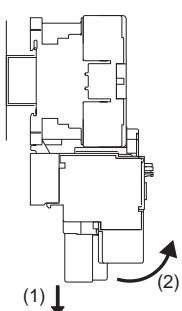

- (1) Hold the product at the top and bottom. Push it downward to release the lower hook.
- (2) Remove the product.

Removing of the thermal overload relay

Follow the procedure below to remove the thermal overload relay with the removal tool (J78KC).

- (1) Insert the removal tool into the release hole.
- (2) Pull out the thermal overload relay in the direction of the arrow while the removal tool is still inserted.
- (3) Pull out the removal tool.

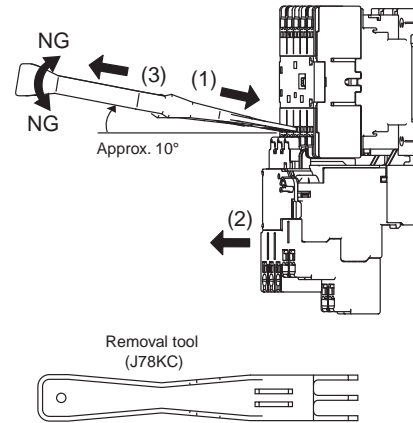

Installation interval

Mount with a separation of at least the dimension shown in the diagram.
 When mounting J7TC units close together, there are no restrictions specifically for the J7TC.
 Follow the instructions for the J7KC that is the mounting base.

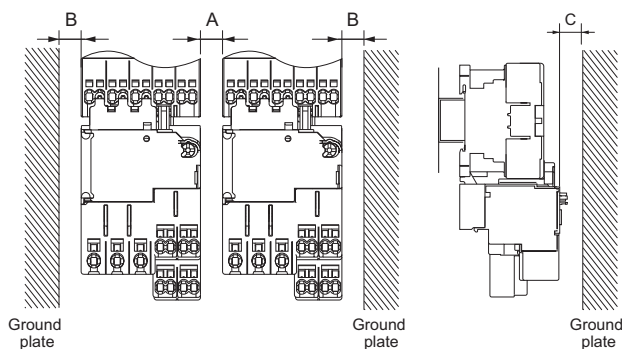

A [mm]	B [mm]	C [mm]
5	10	*

* Set dimension C to an adequate distance for wiring. If the wires have to be bent in a small space, check the minimum bending dimensions with the wire manufacturer before connecting the wiring.

Mounting angle

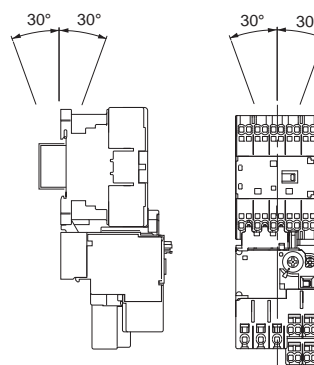

Setting up the thermal overload relay

(1) Current settling [Fig. 1]

Turn the adjustment dial within the scale range to align the motor full-load current to the ▼ mark. Full performance may not be achieved if used outside the scale range. Also, if the thermal overload relay operates unnecessarily at startup due to the type of motor used, increase the settling current value by up to 5% on the dial. Take due care. The motor may not be properly protected if the value is increased too high.

(2) Operation indicator [Fig. 1]

When the thermal overload relay is activated, the white trip indicator is hidden in the operation indicator window.
 (If the relay is activated during an auto reset after it tripped, the white trip indicator is not hidden.)

(3) Sequence check [Fig. 1]

Move the white trip indicator in the direction of the arrow to run a sequence check.

(4) Reset method [Fig. 1]

If the thermal overload relay has been activated, eliminate the overload or other cause of abnormality and then push the reset rod. Push the reset rod in as far as possible. (In this case, the thermal overload relay can only be reset after it cools sufficiently.)

(5) Auto reset state and two-wire circuit

If the circuit is a two-wire circuit and auto reset takes place, the motor will automatically restart when the thermal relay automatically resets.
 Exercise caution.

(6) How to switch from manual reset to auto reset [Fig. 2]

Follow the procedure below to switch from manual reset to auto reset.
 Reverse the procedure to switch back from auto reset to manual reset.

- (1) Open the front cover.
- (2) Hold down the reset rod with a screwdriver and turn it 90 degrees clockwise.
- (3) Make sure that the reset rod is held in the pushed-down position.
- (4) Close the front cover.

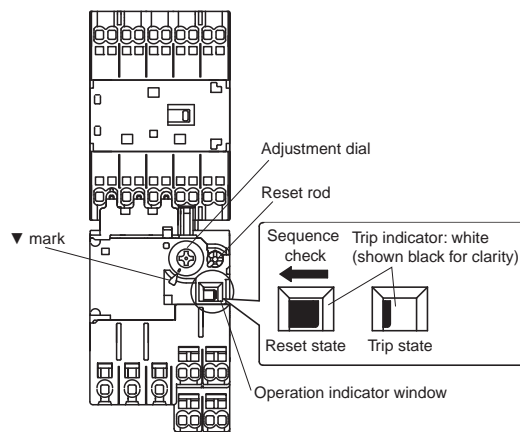

Fig. 1

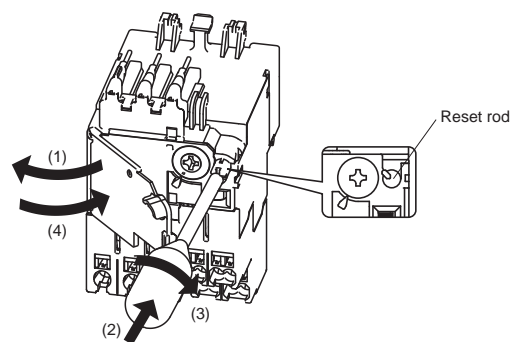
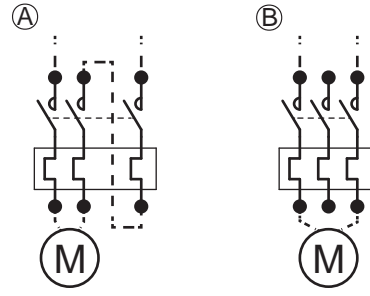

Fig. 2

Application to single-phase or DC motor

As the thermal relay is equipped with a phase failure protection function as standard, if all phases are not energized, the operating current may be low and unnecessary operation may occur. Perform either (A) or (B) when applying the product to single-phase motor circuits or DC circuits.

- (A) Connect the wires so that all poles can be energized in series.
- (B) Set the adjustment dial to an approximately 10% higher value.



Ambient temperature compensation characteristics

Correction of the settling current value according to the operating environment may be required, as the operating current becomes high on the low-temperature side and low on the high-temperature side due to fluctuations in ambient temperature around the thermal overload relay, so that compensation of the operating characteristics tends to be inadequate.

Fig. 3 shows the approximate correction factor for correcting the settling current value according to the ambient temperature.

If the actual ambient temperature differs significantly from 20°C, calculate the corrected settling current value as shown in the example below.

[Example] Calculating the dial settling current value at 55°C ambient temperature

$$\frac{\text{Dial settling current value at } 20^{\circ}\text{C}}{\text{Correction factor for } 55^{\circ}\text{C}} = \text{Dial settling current value at } 55^{\circ}\text{C ambient temperature}$$

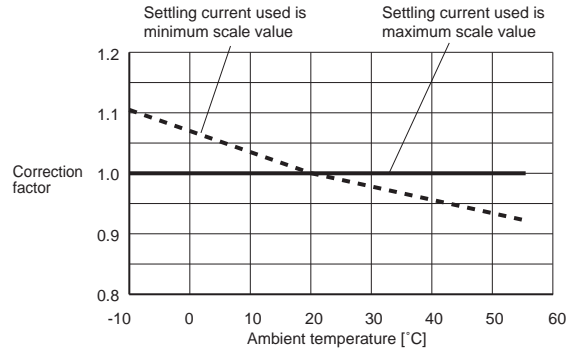
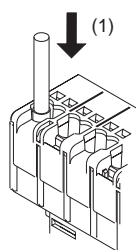

Fig. 3

Wiring

Wire with ferrule



- (1) Insert straight in until the ferrule contacts the terminal block.
- (2) After inserting, pull the wire lightly and check the connection.

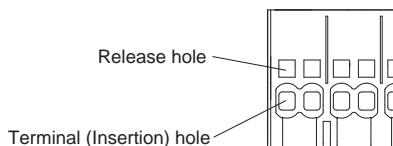

Stranded wire (direct insertion)

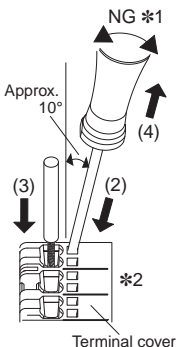

- (1) Before inserting, twist the core wire of the electric wire.
- (2) Insert the recommended tool straight at about 10° angle in the direction of the arrow, into the terminal block until the end touches the release hole.
- (3) With the tool inserted in the release hole, insert straight in until the wire contacts the terminal block.
- (4) Remove the tool from the release hole.
- (5) After inserting, pull the wire lightly and check the connection.

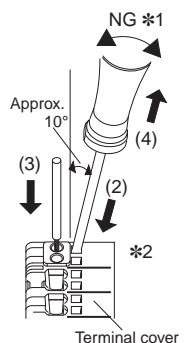

- * When using an insulation stop After inserting the insulation stop into the terminal (insertion) hole all the way to the base, perform steps (1) to (5). The insulation stop will insert easily if you insert at a slight angle to the terminal (insertion) hole and twist as you press it in.
- *1. Do not prying by the tool.
- *2. If the terminal cover comes off because you pried with the tool, do not reuse it.

Removing wire

Common for electric wires with ferrules and stranded wires (direct wiring)

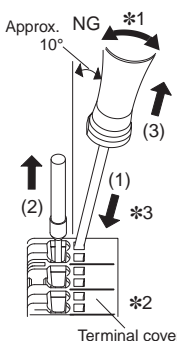

- (1) Insert the recommended tool straight at about 10° angle in the direction of the arrow, into the terminal block until the end touches the release hole.
- (2) With the tool still inserted into the release hole, remove the wire from the terminal insertion hole.
- (3) Remove the tool from the release hole.

- *1. Do not prying by the tool.
- *2. If the terminal cover comes off because you pried with the tool, do not reuse it.
- *3. The inside of the release hole is electrically live. Electric shock may result. Do not use a screwdriver with a metal handle. Do not touch the metal part of the tool.

Connection method and application size of the electric wire

- If directly inserting wire, always use tin-plated strand wire.
- Crimp the ferrule for stranded wires that are not tin plated.
- Solid wire and bar terminals cannot be used.

Applicable wire sizes

Applicable wire		Ferrules used				Stranded wires (direct insertion) *4		
		With an insulation sleeve (L = 8 mm, 10 mm)		Without an insulation sleeve (L=10 mm)				
(mm ²)	(AWG)	Size (mm ²)	Main circuit	Auxiliary circuit	Main circuit	Auxiliary circuit	Main circuit	Auxiliary circuit
0.5	20	0.5	---	⊙	---	⊙	---	⊙ (v)
0.75	18	0.75	⊙	⊙	⊙	⊙	⊙	⊙
1		1	⊙	⊙	⊙	⊙	⊙	⊙ (*3)
1.25	16	1.5	⊙	⊙	⊙	⊙	⊙	⊙
1.5		1.5	⊙	⊙	⊙	⊙	⊙	⊙
2	14	2 (*2)	⊙	⊙	⊙	⊙	⊙	---
2.5		2.5	⊙	⊙	⊙	⊙	⊙	---

⊙: 2 wires allowed (simultaneous connection for crossover wiring terminals),
 ○: 1 wire allowed, ---: out of specification

*1. For compliance with UL or CSA standards, you must use wires of the following sizes.
 Main circuit: 14AWG
 Auxiliary circuit: 16AWG to 14 AWG

*2. Connection is only possible using 2 mm² FE-2.08-8N-YE and FE-2.08-10N-YE ferrules with insulation sleeves manufactured by Wago.

*3. Use insulation stops.
 Insulation stops cannot be used with ferrules.
 Do not use insulation stops in empty terminals.

*4. Insulation stripping length for stranded wires (direct insertion) is as follows.

0.5 mm² to 1.0 mm² (20AWG to 18AWG): 12 mm ± 1 mm
 1.25 mm² to 2.5 mm² (16AWG to 14AWG): 11 mm ± 1 mm
 When using ferrules, refer to the table of recommended ferrules.

Recommended Ferrules and Crimp Tools

Recommended ferrules

Applicable wire		Ferrule conductor length (mm)	Recommended ferrules							
(mm ²)	(AWG)		With an insulation sleeve				Without an insulation sleeve			
		Insulation stripping length (mm)	Phoenix Contact	Weidmuller	Wago	Insulation stripping length (mm)	Phoenix Contact	Weidmuller	Wago	
0.5	20	8	10	AI 0,5-8	H0.5/14	216-201	---	---	---	---
		10	12	AI 0,5-10	H0.5/16	216-241	10	A 0,5-10	H0.5/10	F-0.5-10
0.75	18	8	10	AI 0,75-8	H0.75/14	216-202	---	---	---	---
		10	12	AI 0,75-10	H0.75/16	216-242	10	A 0,75-10	H0.75/10	F-0.75-10
1/1.25	18/17	8	10	AI 1-8	H1.0/14	216-203	---	---	---	---
		10	12	AI 1-10	H1.0/16	216-243	10	A 1-10	H1.0/10	F-1.0-10
1.25/1.5	17/16	8	10	AI 1,5-8	H1.5/14	216-204	---	---	---	---
		10	12	AI 1,5-10	H1.5/16	216-244	10	A 1,5-10	H1.5/10	F-1.5-10
2	14	8	10	AI 2,5-8	H2.5/15D	216-205	---	---	---	---
		10	12	AI 2,5-10		216-206				
2.5	14	10	12	---	---	---	10	---	H2.5/10	F-2.5-10
		12	14	---	---	---	---	---	---	---
Recommended crimp tool				CRIMPFOX 6 CRIMPFOX 6T-F CRIMPFOX 10S	PZ6 roto	Variocrimp4		CRIMPFOX 6 CRIMPFOX 6T-F CRIMPFOX 10S	PZ6 roto	Variocrimp4

* Make sure that the outer diameter of the wire coating is smaller than the inner diameter of the insulation sleeve of the recommended ferrule.

Ferrule processing dimensions

Dimension (after processing)	Main circuit		Auxiliary circuit		
	Minimum	Maximum	Minimum	Maximum	
L [mm]	0	0.5	0	0.5	
D [mm]	Less than 2.5		Less than 2.5		
Wire size	[mm ²]	0.75	2	0.5	1.5
	[AWG]	18	14	20	16

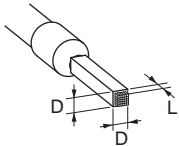

Recommended flat-bladed screwdriver (Recommended tool)

Use a flat-blade screwdriver to connect and remove wires.

Use the flat-blade screwdriver shown in the table below.

The following table shows manufacturers and models as of 2018/Dec.

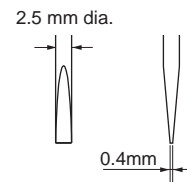

Model	Manufacturer
ESD 0,40×2,5	Wera
SZS 0,4×2,5 SZF 0-0,4×2,5*	Phoenix Contact
0,4×2,5×75 302	Wiha
AEF.2,5×75	Facom
210-719	Wago
SDIS 0,4×2,5×75	Weidmuller
9900 (-2.5×75)	Vessel

* OMRON's exclusive purchase model XW4Z-00B is available to order as SZF 0-0,4×2,5 (manufactured by Phoenix Contact).

Electrical detection

Electricity can be detected by inserting a detector in the release hole.

When inserting a detector, insert it gently while checking for electrical signals. The wire may pull out if the detector is fully inserted.

After detection is complete, immediately pull out the detector and check that the wire is still firmly connected.

Recommended replacement period

Magnetic contactors and switches have a wear life according to the number of switching cycles of their main contacts and mechanical parts. The coil wiring and electronic parts in the electronic unit have a service life resulting from deterioration due to the operating environment and conditions.

You are recommended to replace magnetic contactors and switches after the rated number of switching cycles specified in the catalog, or 10 years after the date of manufacture according to the standard conditions of operation described in the "Survey on Low-voltage Equipment Update Recommendation Times" report prepared by the Japan Electrical Manufacturers' Association (JEMA).

Terms and Conditions Agreement

Read and understand this catalog.

Please read and understand this catalog before purchasing the products. Please consult your OMRON representative if you have any questions or comments.

Warranties.

- (a) Exclusive Warranty. Omron's exclusive warranty is that the Products will be free from defects in materials and workmanship for a period of twelve months from the date of sale by Omron (or such other period expressed in writing by Omron). Omron disclaims all other warranties, express or implied.
- (b) Limitations. OMRON MAKES NO WARRANTY OR REPRESENTATION, EXPRESS OR IMPLIED, ABOUT NON-INFRINGEMENT, MERCHANTABILITY OR FITNESS FOR A PARTICULAR PURPOSE OF THE PRODUCTS. BUYER ACKNOWLEDGES THAT IT ALONE HAS DETERMINED THAT THE PRODUCTS WILL SUITABLY MEET THE REQUIREMENTS OF THEIR INTENDED USE.

Omron further disclaims all warranties and responsibility of any type for claims or expenses based on infringement by the Products or otherwise of any intellectual property right. (c) Buyer Remedy. Omron's sole obligation hereunder shall be, at Omron's election, to (i) replace (in the form originally shipped with Buyer responsible for labor charges for removal or replacement thereof) the non-complying Product, (ii) repair the non-complying Product, or (iii) repay or credit Buyer an amount equal to the purchase price of the non-complying Product; provided that in no event shall Omron be responsible for warranty, repair, indemnity or any other claims or expenses regarding the Products unless Omron's analysis confirms that the Products were properly handled, stored, installed and maintained and not subject to contamination, abuse, misuse or inappropriate modification. Return of any Products by Buyer must be approved in writing by Omron before shipment. Omron Companies shall not be liable for the suitability or unsuitability or the results from the use of Products in combination with any electrical or electronic components, circuits, system assemblies or any other materials or substances or environments. Any advice, recommendations or information given orally or in writing, are not to be construed as an amendment or addition to the above warranty.

See <http://www.omron.com/global/> or contact your Omron representative for published information.

Limitation on Liability: Etc.

OMRON COMPANIES SHALL NOT BE LIABLE FOR SPECIAL, INDIRECT, INCIDENTAL, OR CONSEQUENTIAL DAMAGES, LOSS OF PROFITS OR PRODUCTION OR COMMERCIAL LOSS IN ANY WAY CONNECTED WITH THE PRODUCTS, WHETHER SUCH CLAIM IS BASED IN CONTRACT, WARRANTY, NEGLIGENCE OR STRICT LIABILITY.

Further, in no event shall liability of Omron Companies exceed the individual price of the Product on which liability is asserted.

Suitability of Use.

Omron Companies shall not be responsible for conformity with any standards, codes or regulations which apply to the combination of the Product in the Buyer's application or use of the Product. At Buyer's request, Omron will provide applicable third party certification documents identifying ratings and limitations of use which apply to the Product. This information by itself is not sufficient for a complete determination of the suitability of the Product in combination with the end product, machine, system, or other application or use. Buyer shall be solely responsible for determining appropriateness of the particular Product with respect to Buyer's application, product or system. Buyer shall take application responsibility in all cases.

NEVER USE THE PRODUCT FOR AN APPLICATION INVOLVING SERIOUS RISK TO LIFE OR PROPERTY OR IN LARGE QUANTITIES WITHOUT ENSURING THAT THE SYSTEM AS A WHOLE HAS BEEN DESIGNED TO ADDRESS THE RISKS, AND THAT THE OMRON PRODUCT(S) IS PROPERLY RATED AND INSTALLED FOR THE INTENDED USE WITHIN THE OVERALL EQUIPMENT OR SYSTEM.

Programmable Products.

Omron Companies shall not be responsible for the user's programming of a programmable Product, or any consequence thereof.

Performance Data.

Data presented in Omron Company websites, catalogs and other materials is provided as a guide for the user in determining suitability and does not constitute a warranty. It may represent the result of Omron's test conditions, and the user must correlate it to actual application requirements. Actual performance is subject to the Omron's Warranty and Limitations of Liability.

Change in Specifications.

Product specifications and accessories may be changed at any time based on improvements and other reasons. It is our practice to change part numbers when published ratings or features are changed, or when significant construction changes are made. However, some specifications of the Product may be changed without any notice. When in doubt, special part numbers may be assigned to fix or establish key specifications for your application. Please consult with your Omron's representative at any time to confirm actual specifications of purchased Product.

Errors and Omissions.

Information presented by Omron Companies has been checked and is believed to be accurate; however, no responsibility is assumed for clerical, typographical or proofreading errors or omissions.

Note: Do not use this document to operate the Unit.

OMRON Corporation Industrial Automation Company

Kyoto, JAPAN

Contact : www.ia.omron.com

Regional Headquarters

OMRON EUROPE B.V.

Wegalaan 67-69, 2132 JD Hoofddorp
The Netherlands
Tel: (31) 2356-81-300 Fax: (31) 2356-81-388

OMRON ELECTRONICS LLC

2895 Greenspoint Parkway, Suite 200
Hoffman Estates, IL 60169 U.S.A.
Tel: (1) 847-843-7900 Fax: (1) 847-843-7787

OMRON ASIA PACIFIC PTE. LTD.

438B Alexandra Road, #08-01/02 Alexandra
Technopark, Singapore 119968
Tel: (65) 6835-3011 Fax: (65) 6835-3011

OMRON (CHINA) CO., LTD.

Room 2211, Bank of China Tower,
200 Yin Cheng Zhong Road,
PuDong New Area, Shanghai, 200120, China
Tel: (86) 21-6023-0333 Fax: (86) 21-5037-2388

Authorized Distributor:

©OMRON Corporation 2019-2023 All Rights Reserved.
In the interest of product improvement,
specifications are subject to change without notice.

CSM_7_1

Cat. No. J231-E1-08 1123 (0919)